

INDUSTRIA 2 t, FEM/ISO 3m/M6, long drum - 5 m/min, low voltage control with



Electric winch 2000 kg. Range of electric winches initially designed to satisfy the needs of the industrial sector.

Use:

- All lifting or pulling/hauling applications
- Industry
- Building and public works
- Integration into cranes...
- Pulling/hauling of heavy loads
- Conveyor belt tensioning
- Opening hatches
- Lifting sluice gates
- Stage industry...

Comply with Machines Directive 2006/42/EC and standard NF 14492-1.

Technical properties

- Robust and highly compact.
- Vertical mounting possible.
- 230 V single-phase or 230/400 V - 50 Hz three-phase brake motor. IP 55 Protection. Other voltage or frequencies optional. P = 2,2 kW.
- Motor position: horizontal (possibility of vertical on request).
- The low voltage control protects the user from electrical risks. It makes it possible to operate a wide range of options: from limit switch to radio control, including a load limiter and a rope slack switch...
- The tie-rods are mobile according to the rope outlet.
- FEM/ISO 3m/M6 classification.
- Model with long drum.
- Anti-escape system for the rope.
- Reduced space between the tie-rod and the drum.
- Rope-press roller and rope slack switch incorporated under the upper tie-rod (incorporation into the tie-rod as an option).
- Reliable electric and electronic components.
- Limit switch obligatory when lifting and from 1000 kg, load limiter.
- Sealed electrical unit on the winch model with frequency inverter consisting on: frequency inverter, braking resistance, not disconnectable pendant control with potentiometer (3 m of cable).
- Adjustable speed from 10 % to 100 % with potentiometer.
- Acceleration and deceleration programming tables. According to use, speed programming.
- Reduced-maintenance planetary reduction gears.
- Numerous rope outlet possibilities.
- Options available: rope-press roller, grooved drum, specific paint, drum length on request, phases detector, lower

chassis, timer, tarpauline cover...

Technical characteristics of INDUSTRIA 2 t, FEM/ISO 3m/M6, long drum - 5 m/min, low voltage control with frequency inverter

References	INDUS3M_L_2T_05
Capacity 1st layer kg	2750
Capacity top layer kg	2000
Nb of layers	3
Wire rope cap. 1st layer m	13
Max. rope capacity m	128
Wire rope Ø mm	13
Adjustable speed 1st layer m/min	0,4-4
Adjustable speed top layer m/min	0,5-5
FEM	3m
Motor kW	2,2
Power	1Ph-230V or 3Ph-230/400V
Weight (without wire rope) kg	285

Dimensions

References	INDUS3M_L_2T_05
A mm	1300
B mm	420
C mm	579
D mm	Ø 267
E mm	600
F mm	840
G mm	330
H mm	Ø 16
I mm	45
J mm	32
K mm	295
M mm	165
N mm	823
O mm	578

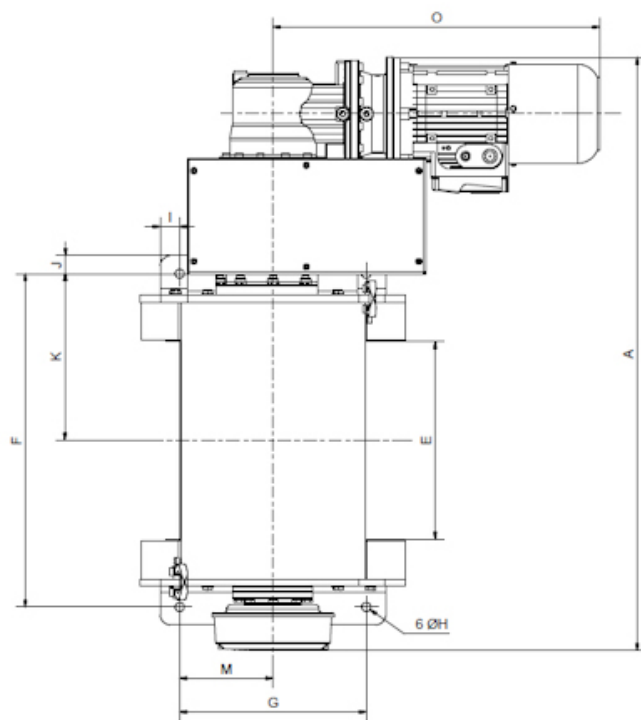
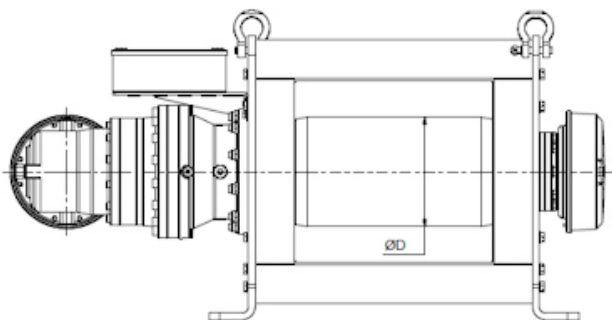
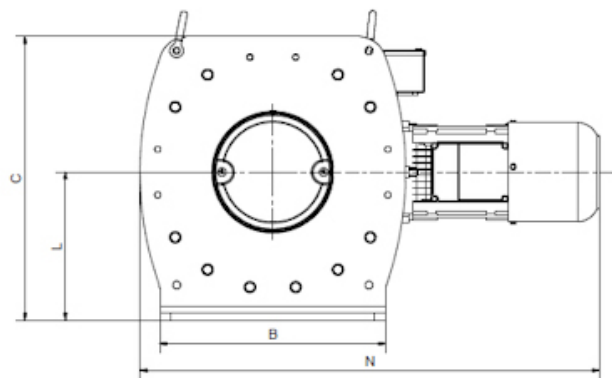

Technical characteristics of the other models of the range



HUCHEZ's advice

These compact winches satisfy the needs of the industrial sector. Mobile tie-rods according to the rope outlet.
Numerous options available.



HUCHEZ
4, rue Michel HAMMID
60420 FERRIERES – France
☎ +33 (0) 3 44 51 11 33
🌐 www.huchez.com
✉ contact@huchez.fr



SERVICE CLIENTS
ATENCIO AL CLIENTE
KUNDENSERVICE

Pour en savoir plus, n'hésitez pas à nous contacter!
To know more, please contact us!
Para más información, póngase en contacto con nosotros!
Für weitere Informationen können Sie sich gerne an uns wenden!