

## Steel bearing sheaves for wire rope 503, wire rope $\varnothing = 20/22$ mm

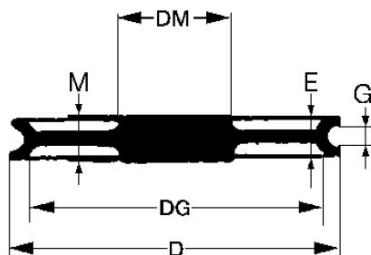

### Technical properties

#### Technical characteristics of Steel bearing sheaves for wire rope 503, wire rope $\varnothing = 20/22$ mm

References	503510
Max. capacity on rope (kg)	12500
Max. rope $\varnothing$ mm	20/21/22
Weight kg	59

### Dimensions

References	503510
External $\varnothing$ (D) mm	510
Tread sheave $\varnothing$ (DG) mm	440
Axis $\varnothing$ mm	110
Bearing mm	6222 2RS

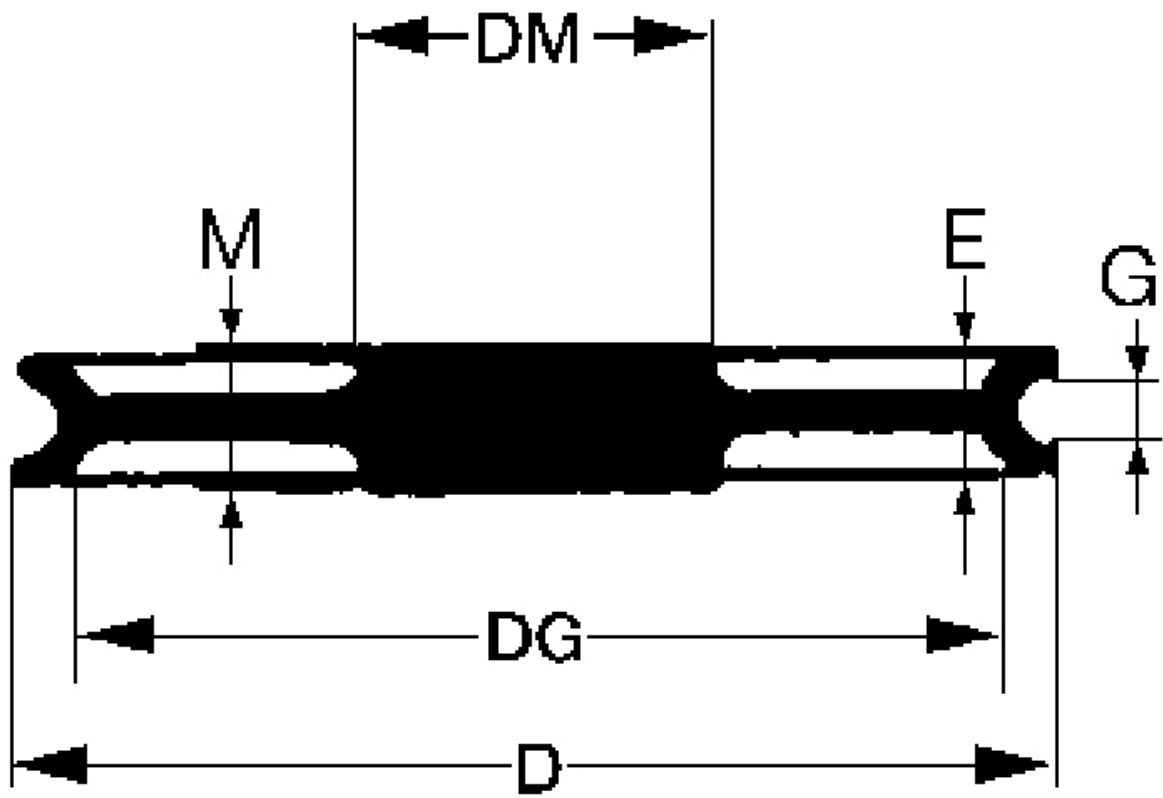

## Technical characteristics of the other models of the range

References	503150	503200	503235	503297	503375
Max. capacity on rope (kg)	1000	1600	2500	4000	6300
Force on rope kg at 90°					
Max. rope Ø mm	6/7	8/9	10/11	12/13	15/16
Weight kg	2,1	4,4	7,5	12,5	24,5

References	503425	503510	503570
Max. capacity on rope (kg)	8000	12500	16000
Force on rope kg at 90°			
Max. rope Ø mm	17/18	20/21/22	22/23/24
Weight kg	35	59	115



HUCHEZ  
4, rue Michel HAMMID  
60420 FERRIERES – France  
☎ +33 (0) 3 44 51 11 33  
🌐 [www.huchez.com](http://www.huchez.com)  
✉ [contact@huchez.fr](mailto:contact@huchez.fr)



SERVICE CLIENTS  
ATENCIO AL CLIENTE  
KUNDENSERVICE

Pour en savoir plus, n'hésitez pas à nous contacter!  
To know more, please contact us!  
Para más información, póngase en contacto con nosotros!  
Für weitere Informationen können Sie sich gerne an uns wenden!